

REV.	DATE	ECN NO.	MODIFICATION	APPROVER
A0	2019.12.21	/	NEW	Jason
A1	2022.02.21	RD00322022101	更新压料孔图面	Able

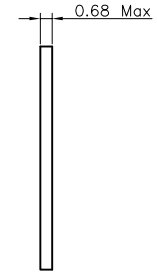
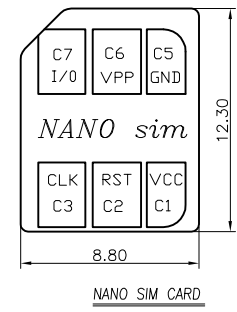
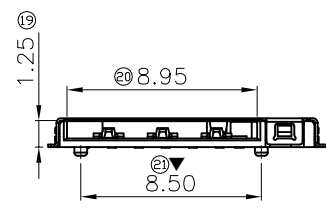
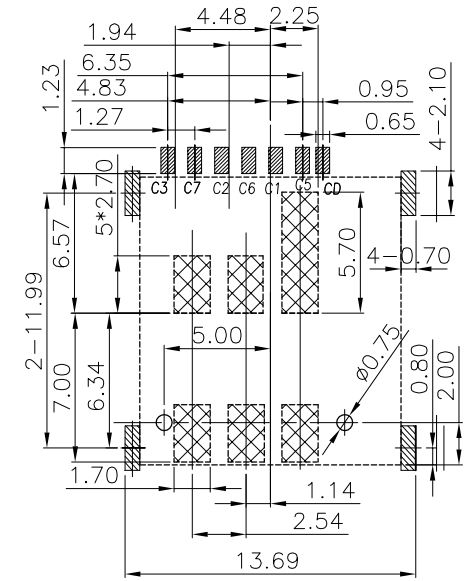
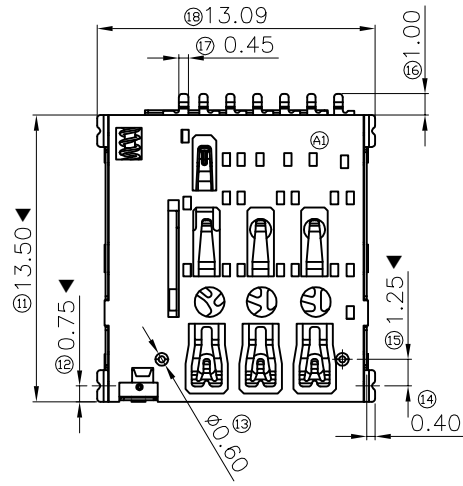
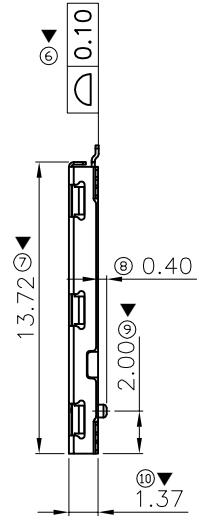
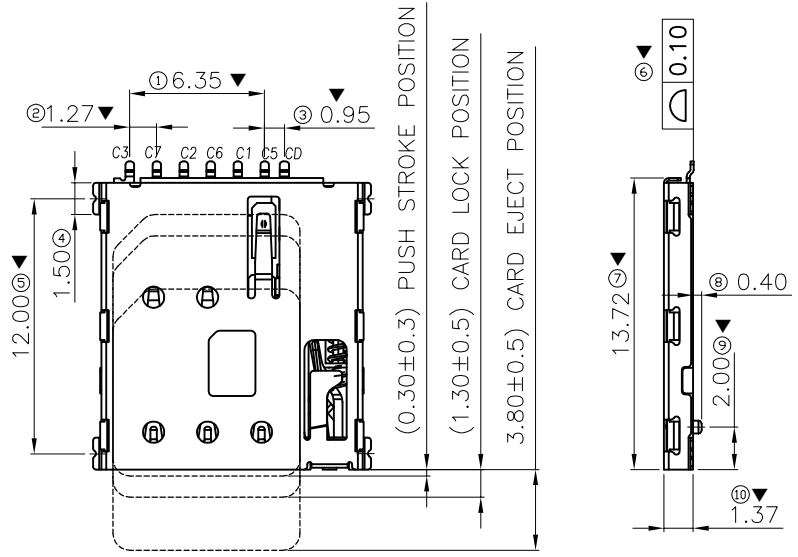

**Note:**  
 1.Material:  
 1.1 Housing:Thermoplastic UL94V-0  
 1.2 Contact:Copper alloy,Gold plated on the contact area,Gold plated on solder area.  
 1.3 Shell:SUS, Ni plated over all.  
 2.Electrical:  
 2.1:Curuent Rataing:0.5A MAX  
 2.2:Contact Resistance:50mΩ Max  
 2.3:Dieelectric withstanding voltage:500V AC  
 2.4:Insulation Resistance:1000MΩ MIN  
 2.5:Durability:3000 Cycles  
 2.6:Operating temperature:-25~+85℃.  
**MAJOR DIMENSION:▼**  
**LEAD FREE AND ROHS COMPLIANT PRODUCT**

PAD AREA  
 KEEP OUT AREA  
 GND PATTERN ONLY  
 NO COPPER AREA (NO Trace&Via&GND)  
RECOMMENDED PCB LAYOUT  
 GENERAL TOLERANCE ±0.05

SIM pin Assignment	
PIN#	Name
C1	VCC
C2	RST
C3	CLK
C5	GND
C6	VPP
C7	I/O

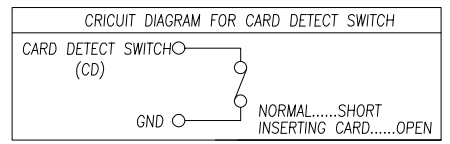

GENERAL TOLERANCE			UNITS mm	NAME(INTENDED USE) 卡座
SELECT	TOL	ON.		
	1	2	3	PART NO.(INTENDED USE) <b>RSS109C-01200</b>
X.XXX	±0.10	±0.15	±0.20	
X.XX	±0.15	±0.20	±0.25	
X.X	±0.20	±0.25	±0.30	
X.	±0.25	±0.30	±0.50	
ANGLE	±2'			

	SCALE	SHEET	REV.
	1:1	1/1	A1